



# LED Cargo Light

With Motion Sensor

---

## Kits 23003611SK and 23003612SK

### Contents

<i>Introduction.....</i>	<i>2</i>
<i>Notes, Cautions, and Warnings.....</i>	<i>3</i>
<i>Recommended Tools.....</i>	<i>4</i>
<i>Kit Parts List .....</i>	<i>5</i>
<i>Installation Instructions.....</i>	<i>6</i>
<i>Revision Control .....</i>	<i>13</i>
<i>Important Notices .....</i>	<i>13</i>

### Customer Service

**574-848-2073**

**Monday–Friday 8 a.m. to 5 p.m. Eastern Standard Time Zone**

**Email: [Parts@Utilimaster.com](mailto:Parts@Utilimaster.com)**

*NOTE: The information in this document is generic. Images and procedures may differ from those for vehicles you are servicing. Because Utilimaster manufactures customized vehicle solutions, this document cannot list and illustrate every possible option for every vehicle. The most common body options are described here. Use this information as a guideline.*

## Introduction

This document provides instructions for the installation of LED cargo light with motion sensor designed for Utilimaster Corporation into the Ram ProMaster™ cargo van.

This manual contains drawings and photos to aid in servicing the vehicle. It may include maintenance information on some items provided but not manufactured by Utilimaster Corporation. Items such as drivetrain components and certain interior furnishings may be covered by separate manufacturer-supplied information. Information provided here is intended to assist Utilimaster customers and is in no way meant to replace or supersede instructions provided by other suppliers for their products.



*LED cargo light with motion sensor*

## Notes, Cautions, and Warnings

Reading through the procedures, you will see NOTES, CAUTIONS, and WARNINGS. Each is there for a specific purpose.

NOTES give additional information that will help you complete the procedure.

CAUTIONS warn against making an error that could damage the vehicle.

WARNINGS remind you to be careful when there is risk of personal injury.



***When you see this symbol, read this statement first! This alert highlights information that may reduce the risk of personal injury or vehicle damage.***

Below are some basic WARNINGS that you should heed when you work on the vehicle's body. They are not all-inclusive and common sense must be used when servicing vehicles.

- Always read and understand all instructions before starting.
- Always wear safety glasses and other appropriate protective equipment (gloves, steel-toed shoes, face shields, knee pads, hearing protection).
- Put the transmission in Park, and set the parking brake before working on the vehicle.
- Be sure that the ignition switch is Off unless otherwise required by the procedure.
- Keep your hair, clothing, and body away from all moving parts such as engine pulleys and power tools.
- Always remove rings, watches, hanging jewelry, and loose clothing before working in tight areas.
- Read and understand all warning labels.
- Always use proper ladders or scaffolding to perform required jobs.
- Always make sure tools are in proper working condition and have guards and safety devices in place.
- Use only the recommended tools for a specific job.
- If at any time you lack confidence in performing a specific repair procedure or in operating the tools safely to perform the repair, STOP! Call your local dealer or a Utilimaster representative.

## Recommended Tools



**WARNING:** Always wear safety glasses and other proper protective equipment (gloves, steel-toed shoes, face shields, knee pads, hearing protection) as appropriate to the process.

Below are some tools that you will need for this process. There may be other commonly used hand tools required but not specifically mentioned.

- Drill with a #11 bit
- Rivet gun
- Electrical tape
- Hand torch
- Sta-Kon terminal crimping tool or equivalent

## Kit Parts List

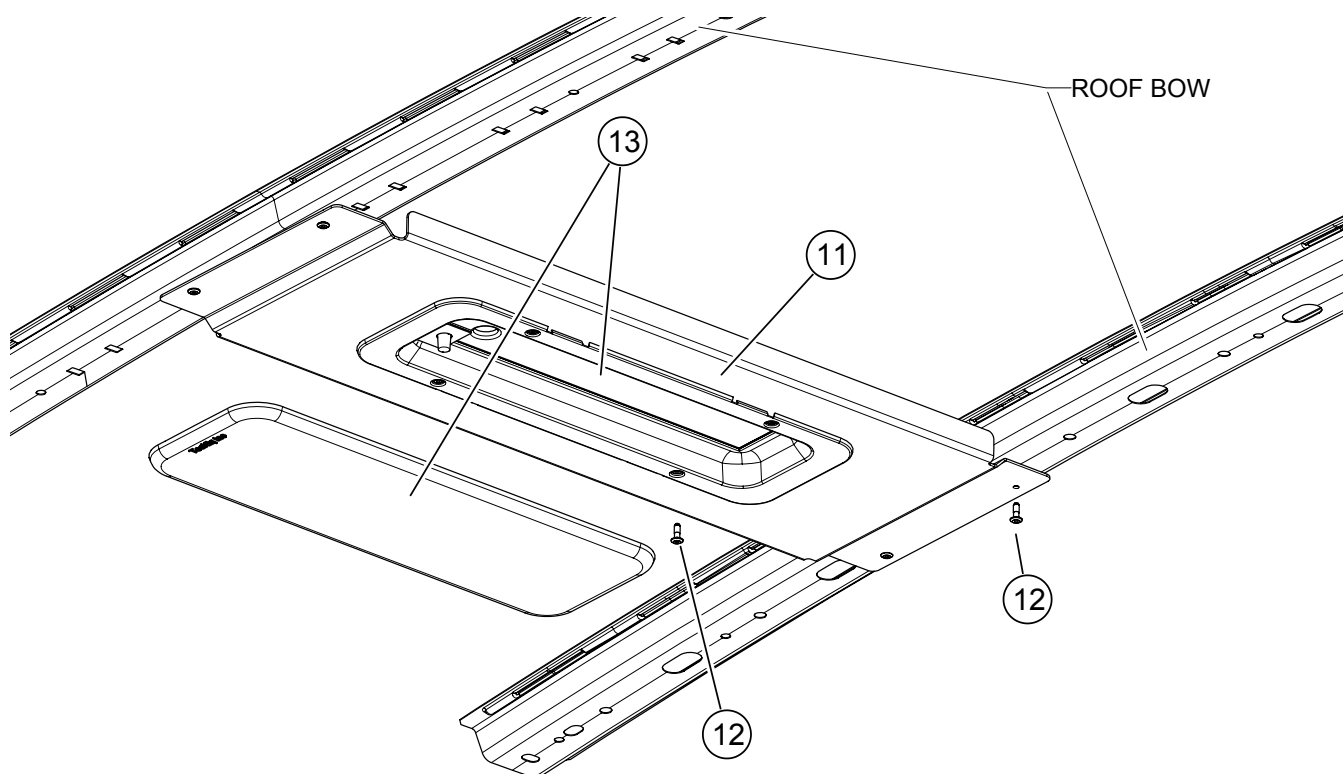

### 136" Wheel Base

23003611SK ProMaster—Light LED Cargo W/ Motion Sensor 136" WB			
BOM ID	PART NUMBER	DESCRIPTION	QTY
0	REFERENCE	23003611a ASM LED DOME LIGHT W/ MOTION L2	
11	06939694	BACKER CARGO LIGHT L2 PRMSTR	1
12	11400620	RIVET 3/16 x 1/16-1/4	8
13	16516689	LIGHT LED DOME 6 X 18 MOTION	1
NS_1	16516790	HARNESS PROMASTER CARGO LIGHT W/ TIMER	1
NS_2	03104592-N005EN	LED CARGO LIGHT W/MOTION SENSOR INSTR	1

### 118" and 159" Wheel Bases

23003612SK Light LED Cargo W/Motion Sensor 118" and 159" WB			
BOM ID	PART NUMBER	DESCRIPTION	QTY
0	REFERENCE	23003612a ASM LED DOME LIGHT W/ MOTION L4 L5	
11	06939695	BACKER CARGO LIGHT L4 L5 PRMSTR	1
12	11400620	RIVET 3/16 x 1/16-1/4	8
13	16516689	LIGHT LED DOME 6 X 18 MOTION	1
NS_1	16516790	HARNESS PROMASTER CARGO LIGHT W/ TIMER	1
NS_2	03104592-N005EN	LED CARGO LIGHT W/MOTION SENSOR INSTR	1

## Installation Instructions

1. Read and understand all instructions before starting work.
2. Validate the packing slip with the list of parts in the instructions.

### Wire Harness Installation



**WARNING:** Always remove the (BLACK) Negative cable first and connect it last.



**WARNING:** Batteries that are improperly connected, jumped, or charged can potentially explode and discharge acid, causing vehicle damage and personal injury. Carefully follow the chassis manufacturer's recommendations for those procedures.



**WARNING:** Battery posts and related accessories may contain lead and lead compounds. Wash hands after handling.



**WARNING:** Always wear proper protective equipment when working around batteries.



**CAUTION:** Note the location of the battery and the cable routing and reinstall in exactly the same way. When reattaching the Positive (RED) cables, the doubling of the two cables must be in the same positions as before.

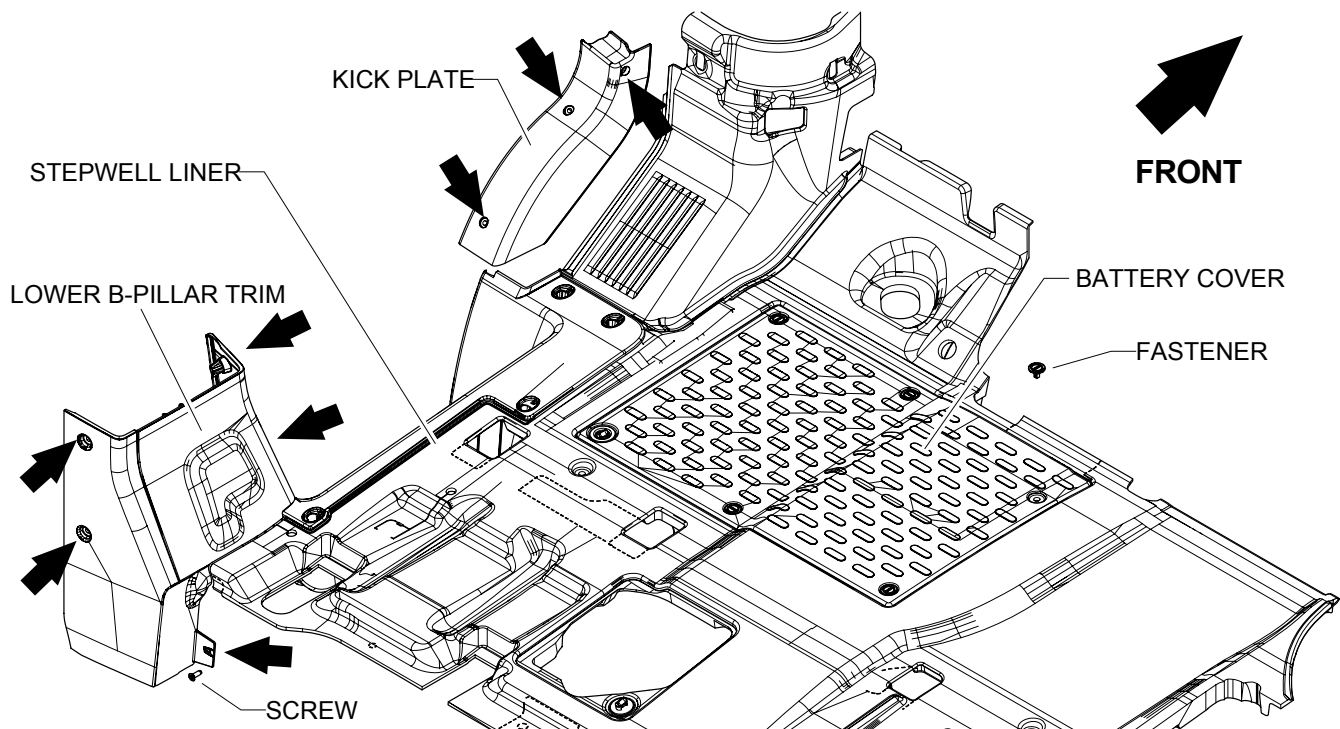

Overview of LH cab floor (seat omitted for clarity)

3. Turn off ignition and all lights.

*NOTE: Keep all fasteners for reinstallation.*

4. Remove (3) screws from the driver's side kick plate and set aside.

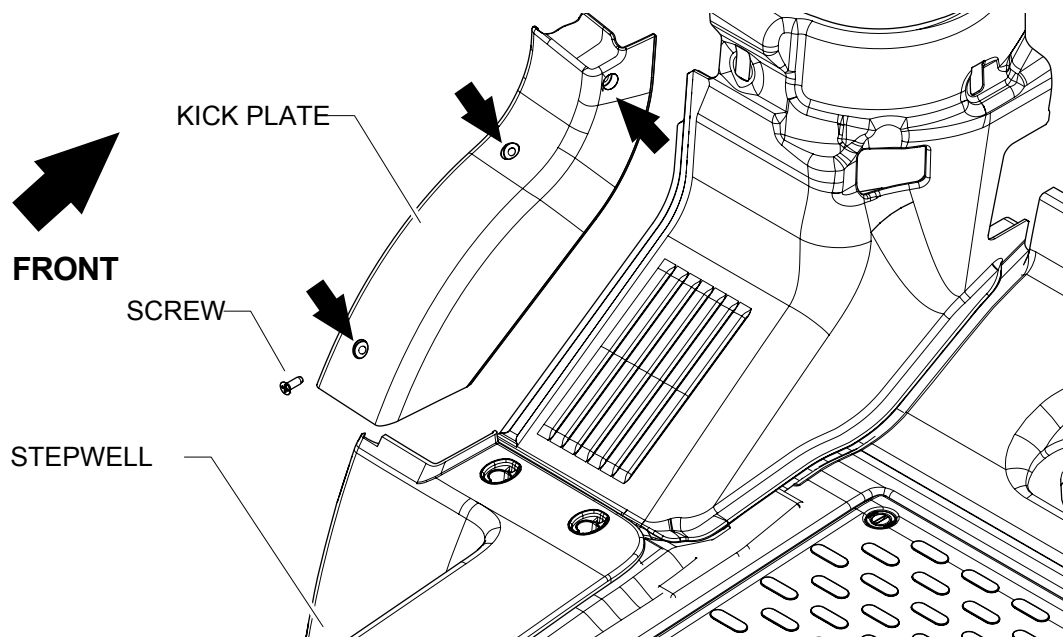

*LH Kickplate fasteners*

5. Remove (3) fasteners from the hand brake cover and set aside.

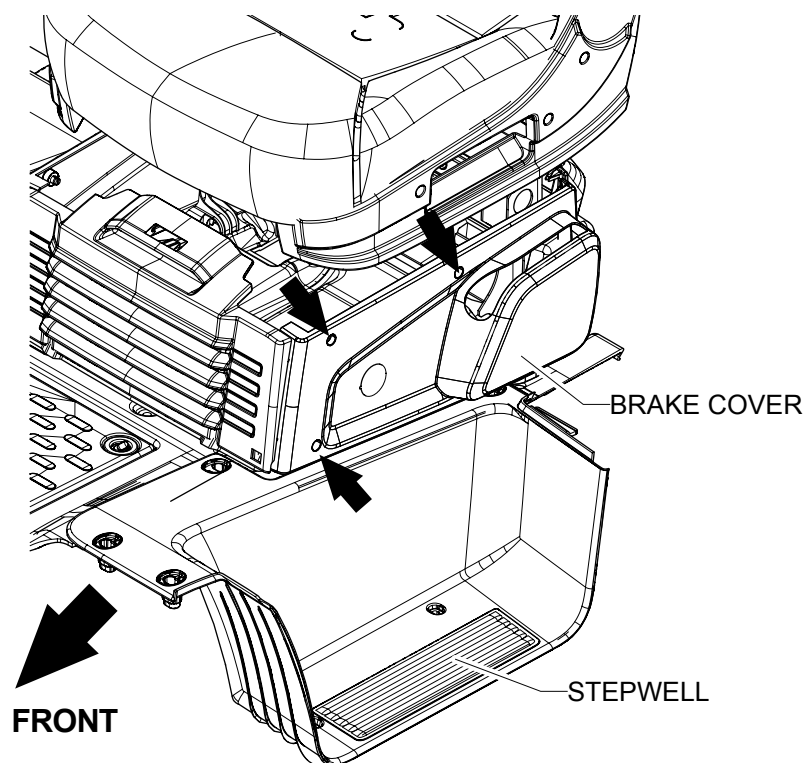

*Hand brake cover fasteners*

6. Remove (5) fasteners from LH lower B-pillar trim and set aside.

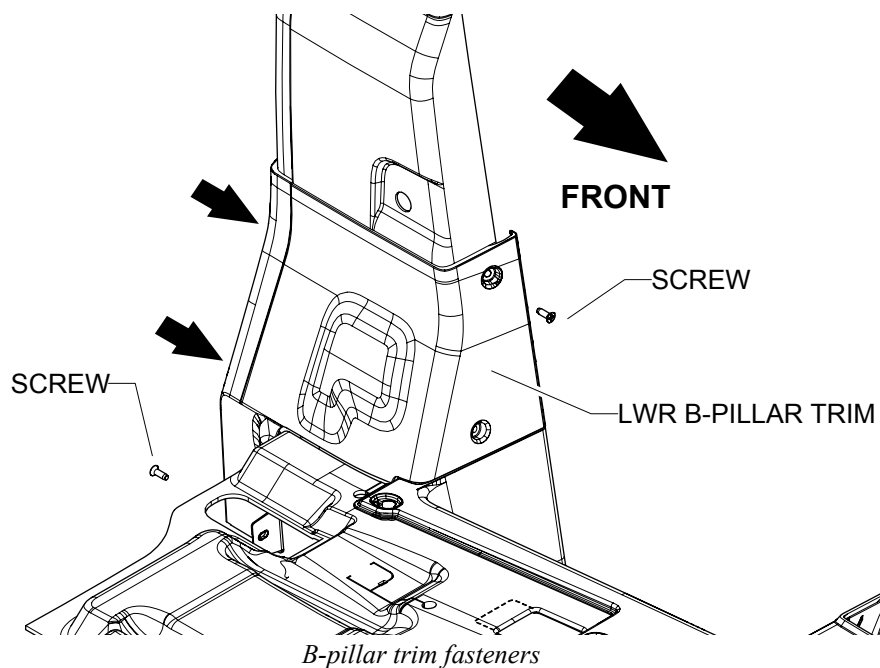

7. Remove screw covers from stepwell and (7) screws and set aside.

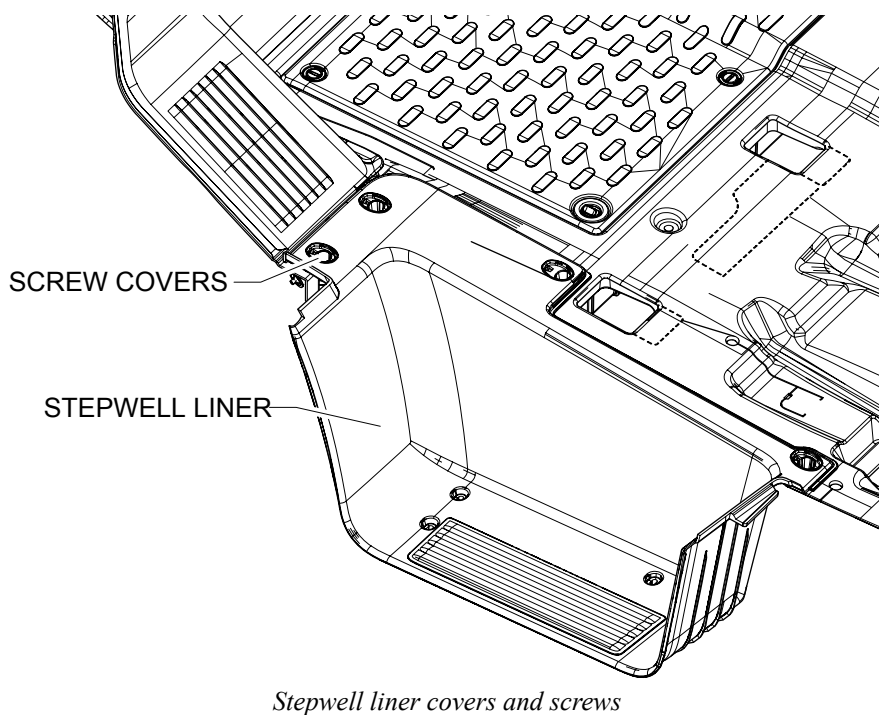



8. Remove battery access cover and master lock cover on positive terminals.

*NOTE: For information on batteries, see the RAM ProMaster User Guide.*

9. Insert harness under cab mat into stepwell harness channel.

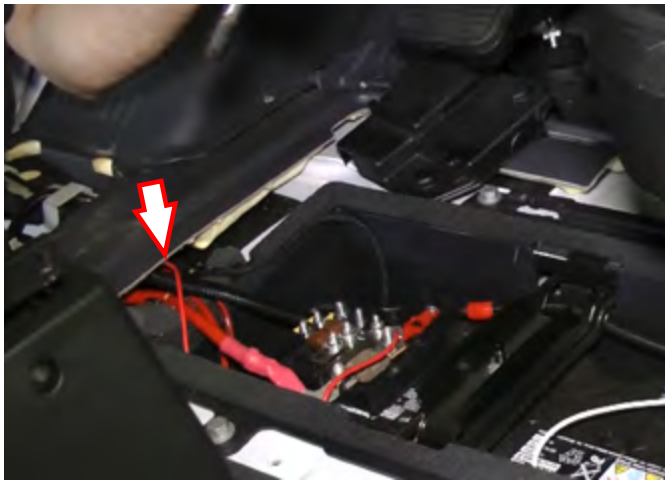

*Harness under LH cab mat*

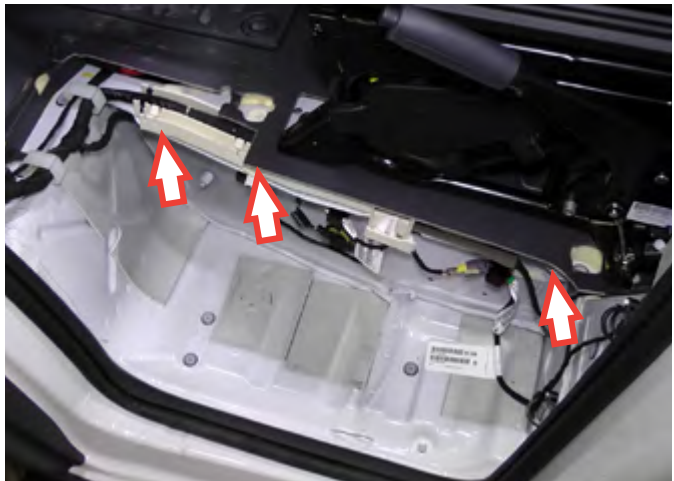

*Harness channel in stepwell*

11. Tuck harness under the cab floor mat and behind the upper B-pillar cover.

12. Route harness behind the RH B-pillar.

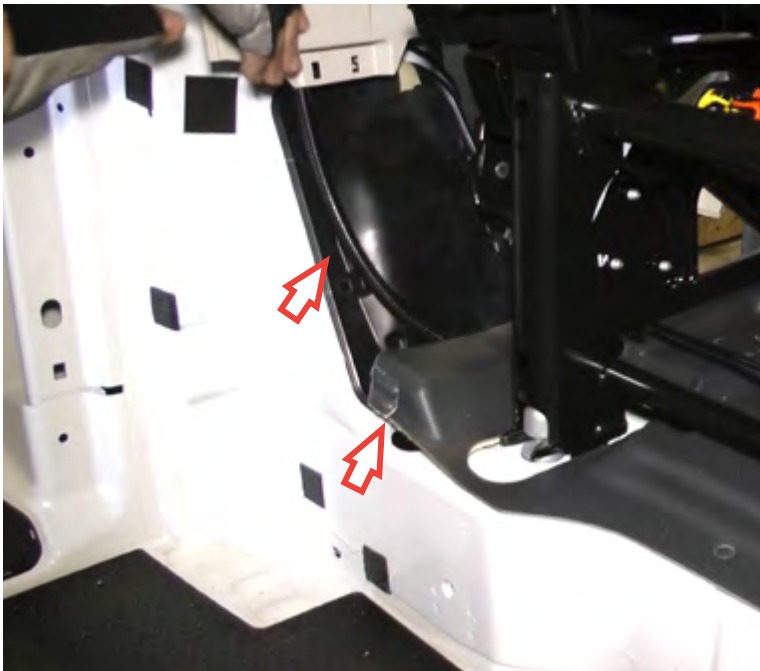

*Harness placed under cab mat at the B-pillar*



*Harness behind LH B-pillar*

13. Route wire harness through the LH harness channel to the center roof bow.

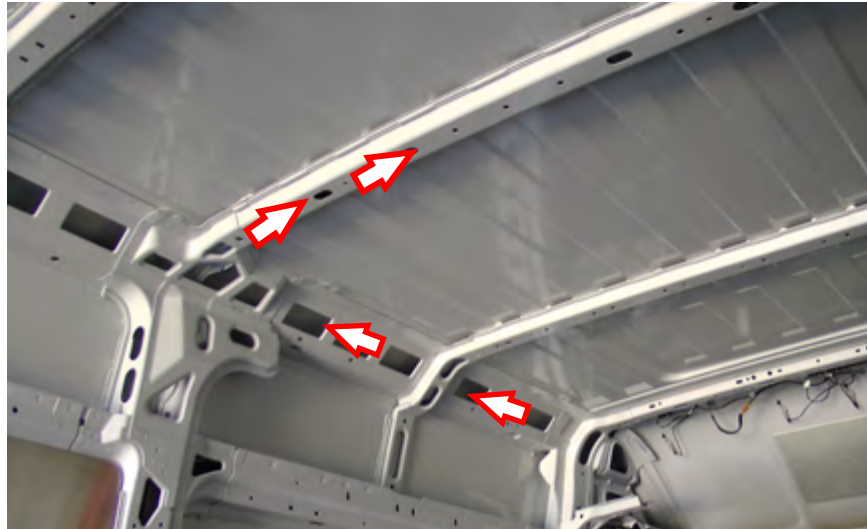

*Harness routing in LH sidewall channel and roof bow*

14. Secure stepwell liner with (7) screws and covers.
15. Secure LH lower B-pillar trim with (5) fasteners.
16. Secure hand brake cover with (3) screws.
17. Secure LH side kick plate with (3) screws.

## Cargo Light Installation



**CAUTION:** Use a drill stop to keep from drilling through the exterior roof panel.

1. Secure light assembly to backer plate using (4) 3/16" rivets and snap in dome cover.

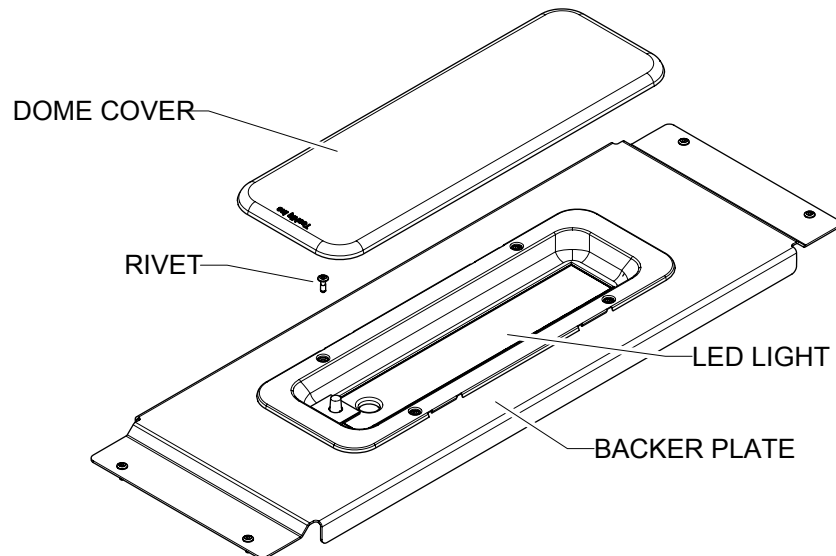

*LED light and backer plate assembly*

2. Use an #11 bit with drill stop and the backer plate holes as a guide to drill (4) holes into the roof bows.



*Drill holes in roof bows*

3. Secure backer plate to roof bows with (4) 3/16" rivets
4. Connect the light to the wire harness.



*Connect harness to light*

5. Secure harness wire loom in battery well.
6. Connect the Positive (Red) and the Negative (Black) terminals to the battery master block and check that light turns on automatically and times off after 30 seconds.



*Terminal connections in battery well*

7. Secure battery master block cover and battery access cover.

## Revision Control

Document Part Number: 03104592-N005EN

Revision: C  
Revision: B  
Revision: A

October 2014  
April 2014  
March 2014

## Important Notices

© 2014, Utilimaster Corp.®

Title: *ProMaster—LED Cargo Light with Motion Sensor*

Utilimaster Corporation attempts to provide information that is accurate, complete, and useful. All information contained in this manual is based on the latest product information available at the time of publication. However, because of the Utilimaster policy of continual product improvement, Utilimaster reserves the right to amend the information in this document at any time without prior notice.

This material is confidential and the property of Utilimaster. It is shared with your company for the sole purpose of helping you with the operation of the described equipment.

Utilimaster makes no warranty of any kind with regard to this material, including, but not limited to, the implied warranties of merchantability and fitness for a particular purpose. Utilimaster shall not be liable for errors contained herein or for incidental or consequential damages in connection with the furnishing, performance, or use of this material.

Utilimaster expressly disclaims all responsibility and liability for the installation, use, performance, maintenance, and support of third-party products. Customers are advised to make their independent evaluation of such products.

No part of this document may be photocopied, reproduced, or translated to another language without the prior written consent of Utilimaster.

Utilimaster® is a registered trademark of Utilimaster Corporation. All other products or name brands mentioned in this document are trademarks of their respective owners.

Browse our web site [www.utilimaster.com](http://www.utilimaster.com) for more information about Utilimaster and its products.